

**EXPLODED VIEW**  
**52ST / 52ST FS**  
 Version 3.1 Version 3.1.F

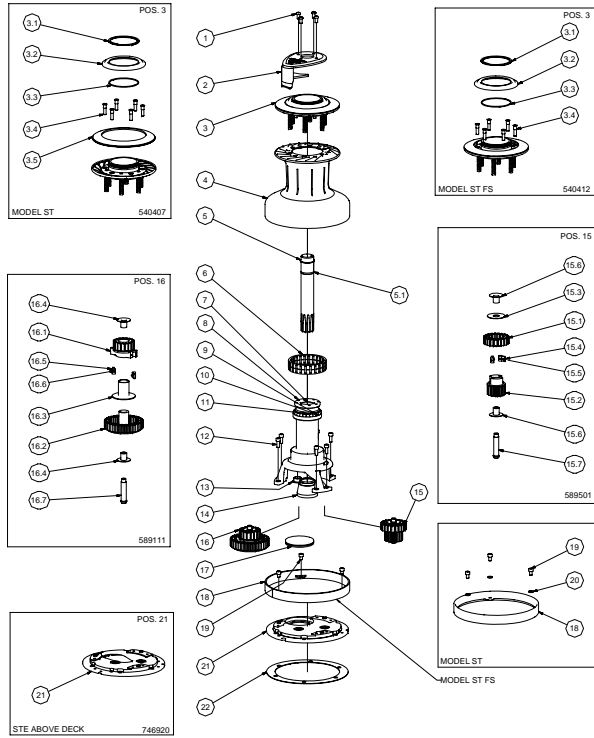

**MOUNTING INSTRUCTION**  
**52ST / 52ST FS**  
 Version 3.1 Version 3.1.F

Installing the winch is easy, if you follow these instructions. The numbers in ( ) refer to the position numbers in the parts list.

**Tools required for the installation:**

- Allen key (4 mm.)
- Allen key (5 mm.)
- Allen key (6 mm.)
- Ø 8.5 mm. (11/32") drill.
- 6 pcs. M8 (5/16") bolts and nuts (length depending on deck thickness).
- 6 x large washers or backing plate.
- Ring spanner to match nuts.
- Bedding compound.

1. Drill bolt holes Ø8,5mm (11/32") using the winch template. Be sure that no dust comes in contact with the winch, while drilling.
2. Remove screws (1).
3. Remove self-tailing arm (2) and drum (4).
4. Apply a light coat of bedding compound, ensuring that each bolt hole is bedded. Keep drain grooves clear.
5. Fasten lower base (21) into place using 6 pcs. M8 (5/16") bolts. Use large washers or a backing plate.
6. Assemble in reverse order.
7. Check that the winch is functioning correctly:  
 The drum should operate smoothly, by turning the drum clockwise by hand.  
 The drum must not turn when trying to turn the drum anti clockwise.  
 While turning the winch handle clockwise the drum should turn slowly.  
 While turning the winch handle anti clockwise the drum should turn fast.

**PARTS LIST**  
**52ST / 52ST FS**  
 Version 3.1 Version 3.1.F

POS.	QTY.	DESCRIPTION	ART. NO.
1	4	Screw	ISO7380-A4-M6x12
2	1	Self-tailing arm	594100
3	1	Self-tailing top complete <i>Model ST</i>	540407
3	1	Self-tailing top complete <i>Model ST FS</i>	540412
3.1	1	Cir clip	591000U
3.2	1	Top ring	521305
3.3	1	O-ring	RD100431
3.4	6	Screw	585160
3.5	1	Disc <i>Model ST (only for 540406)</i>	526910
4	1	Drum complete	734401
5	1	Drive shaft complete	782811
5.1	1	O-ring	RD100302
6	1	Roller bearing complete	525905
7	1	Bushing <i>Not removable</i>	716503
8	1	Upper Base	742310
9	12	Ball, POM	526302
10	11	Ball, stainless steel	526301
11	1	Retaining ring	526600
12	6	Screw	DIN912-A4-M6x16
13	1	Bushing	877000
14	1	Bushing	734900
15	1	Small Ratchet gear complete	589501
15.1	1	Ratchet gear wheel	525200
15.2	1	Gear wheel	525103
15.3	1	Disc	524300
15.4	2	Pawl	713200
15.5	2	Arm spring	713300
15.6	2	Bushing	981410
15.7	1	Shaft for Ratchet gear	980410
16	1	Ratchet gear complete	589111
16.1	1	Gear wheel	525403
16.2	1	Ratchet gear wheel	525300
16.3	1	Bushing	525500
16.4	2	Bushing	981410
16.5	2	Pawl	713200
16.6	2	Arm spring	713300
16.7	1	Shaft for Ratchet gear	980410
17	1	Plug for deck plate	783900
18	1	Base cover <i>Model ST</i>	734303
18	1	Base cover <i>Model ST FS</i>	734321
19	3	Screw <i>Model ST FS</i>	DIN912-A4-M6x8
19	3	Screw <i>Model ST</i>	DIN912-A4-M6x10
20	3	Washer <i>Model ST</i>	DIN127-A4-Ø6,2
21	1	Deckplate for Above Deck STE compact motor	746920
21	1	Deckplate for Below Deck motor and manual operated winch	746910
22	1	Sealing for Aluminium deck <i>Not included</i>	746990
1		<b>Service kit No. 21 (Not included)</b>	<b>710021</b>

**SERVICE INSTRUCTION**  
**52ST / 52ST FS**  
 Version 3.1 Version 3.1.F

**Tools required for service:**

- Allen key (4 mm.)
- Allen key (5 mm.)
- Screwdriver (small).
- Winch handle.
- ANDERSEN winch grease

1. Remove screws (1).
2. Remove self-tailing arm (2) and drum (4).
3. Remove screws (12).
4. Remove upper base (8), and place it in a safe and comfortable place before dismantling it !
5. Remove drive shaft (5), by using a finger or a winch handle.
6. To release the roller bearing (6), gently insert a small screwdriver between roller bearing and base plate (8). Remove roller bearing.
7. Remove shafts (15.7, 16.7).
8. Remove and dismantle the two gear units.
9. Clean all parts in benzine. Remember to clean the gear teeth, roller bearing track and bushing inside the drum (4).
10. Assemble in reverse order. During assemble, lightly grease all gear teeth, drive shaft, roller bearing, shafts, pawls, springs and bushings by the use of a small soft brush. Pawls should only be lubricated with a very thin film of ANDERSEN WINCH GREASE. It is very important that pawls can move freely.

**IMPORTANT:** When assembling the winch, check the functioning of each pawl by pushing the pawl against the spring. The pawls should move smoothly and automatically return to their normal position, where the pawls engage with the teeth. If the pawls do not function correctly, clean and lubricate the pawls and gears. Check the function of the pawls again to make sure that it works correctly. If the pawls do not work correctly replace the springs and recheck the function. Malfunctioning pawls may lead to unexpected failure of a loaded winch resulting in material damage or fatal personal injury.

Service Kit No. 21 (art. no. 710021) contains spare parts for this winch.

**GENERAL INFORMATION**

Due to the best choice of materials and high precision in manufacturing, we recommend, for normal use, only to dismantle, clean and lubricate the winch once every second year. Under extensive use, such as racing, charter or blue water sailing, we recommend to lubricate the winch once every year.

We strongly recommend always to use ANDERSEN WINCH GREASE, when lubricating your winch. ANDERSEN WINCH GREASE is a high quality silicone/Teflon grease product. Most other types of grease, including "marine grease" are not suitable for lubrication of winches. Non-suitable grease products can cause malfunction, which could result in fatal injuries for the user and others.

Pawl arm springs should be replaced every second year. Spare arm springs and other parts that may be required are included in the ANDERSEN Service Kit. Please refer to the service instruction for the Service Kit suitable for the specific winch.

When the winch handle is not in use but the winch is under load, we recommend, from a safety point of view, to remove the winch handle from the winch.

To ensure correct function of the selftailing unit, only use recommended line sizes. When using the winch with mooring lines DO NOT use the selftailing function and be sure that the mooring line is not in contact with the selftailing arm.

To ensure the best possible functioning of the winch, we recommend that the winch is placed in accordance with the line entry shown below.

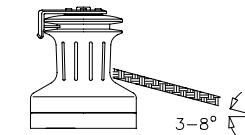

Be also aware that selftailing arm is positioned correctly. We recommend to have the selftailing arm positioned within the shaded area. On 12ST and 28ST the position of the selftailing arm is fixed, making it very important to establish the proper location of the holes prior to drilling these in the deck. On all other models, the selftailing arm can be placed in several different positions after having installed the winch.

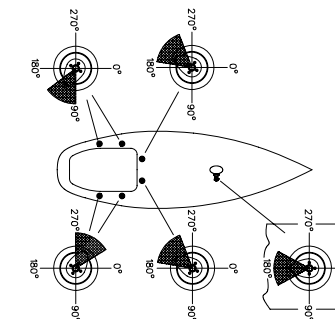

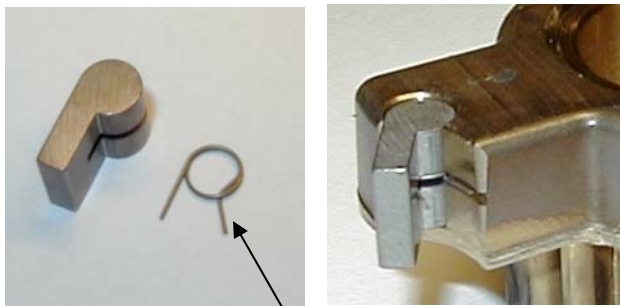

Note the curved spring "arm"

### LIMITED WARRANTY

- 1.1 ANDERSEN issues a three-year warranty on all their products covering manufacturing and material defects on condition that the products are used in normal fashion. The warranty shall apply for three years from the moment ANDERSEN sell the product concerned (to the first buyer).
- 1.2 Within the period of the warranty, and in accordance with the terms of the warranty, ANDERSEN undertake to replace or repair all defective components, which have been used in normal fashion.
- 1.3 The warranty is however subject to the limitations and exceptions outlined below.
- 2.1 **Conditions and limitations:**  
ANDERSEN's liability shall be limited to repair or replacement of components, which are defective owing to manufacturing or material defects.
- 2.2 ANDERSEN assume no other liability than this, not even liability for indirect losses caused by defect concerned, including operating losses, loss of profits, or damage caused to real property or moveable property occurring while the product concerned is in the possession of the Buyer.
- 2.3 The Buyer alone shall bear the responsibility and risk involved as to whether the products are suitable for the application intended. ANDERSEN assume no liability in this connection.
- 2.4 ANDERSEN assume no liability for defects which occur due to use of their products for purposes for which they are not intended, or for defects which occur owing to incorrect installation, corrosion, ultraviolet degradation, lack of maintenance, or any alteration or repair of the product carried out incorrectly by the Buyer. Finally, ANDERSEN assume no liability for normal wear and tear, or for depreciation in value.
- 2.5 ANDERSEN do not assume any liability for service carried out by anyone other than authorised ANDERSEN representatives, unless such service is carried out pursuant to guidelines laid down by ANDERSEN and in accordance with good craftsmanship.
- 2.6 The buyer shall inform ANDERSEN in writing of any defects with no undue delay once defects have been registered. Products being dealt with under the warranty shall be returned to ANDERSEN for repair unless any other agreement has been reached in writing.
- 2.7 ANDERSEN shall not cover costs incurred by the Buyer in connection with the transport or wages involved in a warranty case. The Buyer in full shall meet such costs.
- Exceptions:**
- 3.1 The warranty is only valid for one year in respect of components bought for the products concerned, such as electric motors, electric equipment, hydraulic pumps, motors and valves.
- 3.2 ANDERSEN assume no liability for consequential damage of ships, equipment, property or people caused by defects in ANDERSEN products.
- 3.3 The company's products are subject to continuous development, and consequently ANDERSEN reserve the right to change designs and specifications without prior notice.

**ANDERSEN Argentina**  
Argen Mast & Systems s.r.l.  
Av. Tiscornia 963  
(1642) San Isidro  
Buenos Aires  
Tel.: 11 4742 44 62  
Fax: 11 4742 44 62  
E-mail: info@agenmast.com.ar  
or rlanzani@argenmast.com.ar

**ANDERSEN Australia**  
Allyacht Spars Australia  
1853 Lytton Rd., Lytton  
Queensland  
Australia 4178  
Tel.: 07 3893 2233  
Fax: 07 3893 2478  
E-mail: info@allyachtspars.com.au  
Web: www.allyachtspars.com.au

**ANDERSEN Austria**  
Robert Lindemann KG  
Wendenstrasse 455  
D-20537 Hamburg  
Tel.: 040 21 11 970  
Fax: 040 21 11 97 30  
E-mail: info@lindemann-kg.de  
Web: www.lindemann-kg.de

**ANDERSEN Belgium**  
Jupiter Handelsmijl, BVBA  
Kontichsesteenweg 67  
B-2630 Aartselaar  
Tel.: 03 457 43 81  
Fax: 03 457 68 21  
E-mail: info@jachtenjupiter.com  
Web: www.jachtenjupiter.com

**ANDERSEN Canada**  
Rekord Marine Enterprises Ltd  
8194 Ontario Street  
Vancouver, B.C., V5X 3E3  
Tel.: 604 325 5233  
Fax: 604 325 0328  
Toll free fax: 1-800-663-6424  
E-mail: steve@rekord-marine.com  
Web: www.rekord-marine.com

**ANDERSEN Croatia**  
Jupiter Handelsmijl, BVBA  
Castropola 54  
HR-52100 Pula  
Croatia  
Tel.: 052 214 542  
Fax: 052 213 558  
E-mail: navela@pu-t.com.hr  
Web: www.navela.hr

**ANDERSEN Czech Republic**  
Nereide Yachting Ltd.  
Vybiralova 972/70  
CZ-19800 Prague 9  
Tel.: 605 25 98 82  
Fax: 257 94 17 84  
E-mail: info@nereide-yachting.com  
Web: www.nereide-yachting.com

**ANDERSEN Denmark**  
WATSKI A/S  
Savsvinget 4  
DK-2970 Hersholm  
Tel.: 45 76 40 11  
Fax: 45 76 40 12  
E-mail: kontakt@watski.com  
Web: www.watski.dk

**ANDERSEN Finland**  
Ky Jotiko-Marine Kb  
Unioninkatu 45  
SF-00170 Helsinki  
Tel.: 500 490239  
Fax: 09 1351404  
E-mail: info@jotiko-marine.com  
Web: www.jotiko-marine.com

**ANDERSEN France**  
Greement Import - Head office:  
13 rue du Chêne Lassé  
Z.I. BP 284  
44803 Saint Herblain  
Tel.: 02 28 03 01 01  
Fax: 02 28 03 19 91  
E-mail: info@greementimport.fr  
Web: www.greementimport.fr

**ANDERSEN Germany**  
Herman Gotthardt GmbH  
Leunastrasse 50  
D-22761 Hamburg  
Tel.: 040 851 50 50  
Fax: 040 850 91 33  
E-mail: info@gotthardt-yacht.de  
Web: www.gotthardt-yacht.de

**ANDERSEN Great Britain**  
IMP  
15 Jarman Way  
Ryton  
Hertfordshire SG8 5HW  
Tel.: 01 763 241 300  
Fax: 01 763 241 770  
E-mail: sales@improducts.co.uk  
Web: www.improducts.co.uk

**ANDERSEN Greece**  
Meltemi Yachting Ltd.  
4, Metamorfoseos st Alimos  
GR-17455 Athens  
Tel.: 210 9849983  
Fax: 210 9844366  
E-mail: info@meltemi-yachting.gr  
Web: www.meltemi-yachting.gr

**ANDERSEN Hungary**  
Marina Yacht Sport  
Csérházi u. 3. H-1078 Budapest  
Tel.: 322 86 55  
Fax: 322 9834  
E-mail: iroda@marina.hu  
Web: www.marina.hu

**ANDERSEN Italy**  
TOMASONI TOPSAIL S.p.A.  
Via E Toti 55  
16035 Rapallo (GE)  
Tel.: 0185 2001  
Fax.: 0185 263 160  
E-mail: andrea@tomasoni.com  
Web.: www.tomasoni.com/technico

**ANDERSEN Netherlands**  
Nautec Engineering B.V.  
Muyterweg 17  
6075 AM Herkenbosch  
Tel.: 0475 537760  
Fax: 0475 537759  
E-mail: info@nautec.nl  
Web: www.nautec.nl

**ANDERSEN New Zealand**  
Nordic Marketing Ltd.  
P.O. Box 100669  
NSMC Auckland  
Tel.: 09 368 4740  
Fax: 09 368 4741  
E-mail: nordic@xtra.co.nz  
Web: www.nordic.co.nz

**ANDERSEN Norway**  
Navimo Nordic AB/- at Termomarin A/S  
Fokserødveien 31  
N-3241 Sandefjord  
Tel.: 33 42 00 90  
Fax: 33 42 00 91  
E-mail: post@termomarin.no  
Web: www.termomarin.no

**ANDERSEN Poland**  
Sail Service  
ul. Sienia 45  
80-605 Gdansk  
Tel.: 58 307 37 85  
Fax: 58 307 09 24  
E-mail: office@sailservice.com.pl  
Web: www.sailservice.com.pl

**ANDERSEN Portugal**  
Just Boats  
CX 248 P, Monte Alquevinho  
Sta Caterina de Fonta do Bispo  
Tel.: 281 971 179  
Fax: 289 994 485  
E-mail: info@just-boats.net  
Web: www.just-boats.net

**ANDERSEN Singapore**  
Alquest Marketing  
66, Tannery Lane  
#02-06B Sindo Building  
Singapore 347805  
Tel.: 6749 9359  
Fax: 6749 9360  
E-mail: jason@alquest.com.sg  
Web.: www.alquest.com.sg

**ANDERSEN Slovenia**  
Tramontana  
Tesovnikova 88  
1000 Ljubljana  
Tel.: 1 568 37 32  
Fax: 1 565 48 88  
E-mail: info@tramontana-net.si  
Web: www.tramontana-net.si

**ANDERSEN South Africa**  
Manex & Power Marine  
5 Industry Street  
P.O. Box 173  
Paarden Eiland 7420 Cape Town  
Tel.: 021 511 7292  
Fax: 021 510 1487  
E-mail: manex@manex.co.za  
Web: www.manex.co.za

**ANDERSEN Spain/Mallorca**  
Yacht Triggers Mallorca, s.l.  
Passeig República Argentina, 34  
baixos  
E-07200 FELANITX (Mallorca)  
Tel.: 971 58 41 30  
Fax: 971 58 41 31  
E-mail: info@yachtriggers.com  
Web: www.yachtriggers.com

**ANDERSEN Spain/Barcelona**  
Pertrechos Nauticos s.l.  
Buscarons, 6 bj, local 2  
08022 Barcelona  
Tel.: 93 418 66 32  
Fax: 93 418 56 48  
E-mail: info@pertrechosnauticos.com  
Web: www.pertrechosnauticos.com

**ANDERSEN Sweden**  
Navimo Nordic AB  
Lundenvägen 2  
S-473 31 Henån  
Tel.: 0304 360 60  
Fax: 0304 307 43  
E-mail: info@navimo.se  
Web: www.navimo.se

**ANDERSEN Switzerland**  
Robert Lindemann KG  
Wendenstrasse 455  
D-20537 Hamburg  
Tel.: 040 21 11 97 0  
Fax: 040 21 11 97 30  
E-mail: info@lindemann-kg.de  
Web: www.lindemann-kg.de

**ANDERSEN Trinidad & Tobago**  
Soca Sails  
Crewsinn Marina, Chaguaramas  
P.O. Box 608  
Trinidad, West Indies  
Tel.: 868 634-4178  
Fax: 868 634-1044  
E-mail: info@socasails.com

**ANDERSEN Turkey**  
Enigma Yacht Supply & Services Ltd.  
Istanbul Deri ve End serbest Bölgesi  
Hasan Yelmen Cad no.: 12  
34957 Tuzla: Istanbul  
Tel.: 216 394 21 44  
Fax: 216 394 22 19  
E-mail: info@enigmayachts.com  
Web: www.enigmayachts.com

**ANDERSEN U.S.A.**  
Scandvik Inc.  
423 4th place SW  
Vero Beach  
Florida 32962  
Tel.: 772 567 2877  
Fax: 772 567 9113  
Toll Free 1-800-535-6009  
E-mail: info@scandvik.com  
Web: www.scandvik.com



Sail Handling by

**ANDERSEN**  
Stainless Steel Winches